

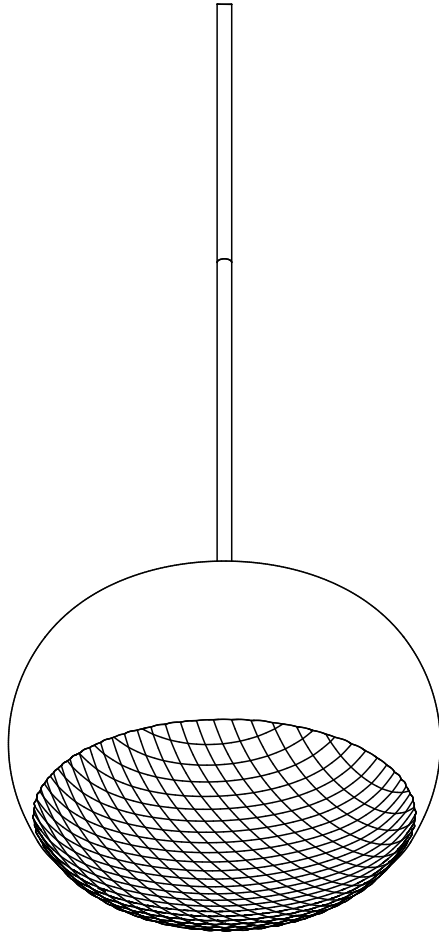

Print Stem Pendant

Low Voltage Input

12727 rA



CAUTION:

Before starting, turn off power
at main circuit panel.

ADVERTENCIA:

Antes de comenzar la instalación,
apague la corriente en el tablero
principal.

ATTENTION:

Coupez l'alimentation avant de
procéder à l'installation.



Calling for backup? Scan above
to contact our team.

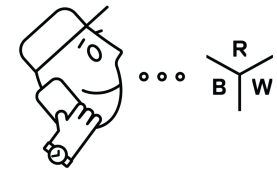
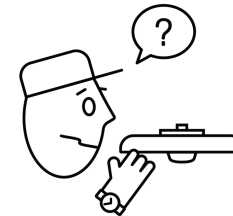

www.RBW.com

+1 212 388 0399

support@RBW.com

© RBW Studio LLC, 2013, 2020

Globe Finish

- Glass Clear/Frosted
- Plastic Clear

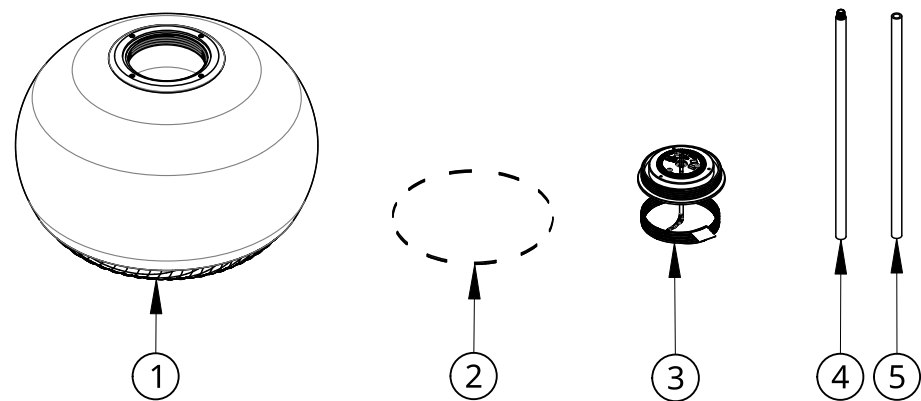

Item	Qty	Part number	Description
1	1	12558	Assembly: Print Large Globe Clear & Frosted Glass
2	1	XXXXX	Canopy Kit
3	1	12062-27	Assembly: Print Pendant (Stem) Module. RBW LED 65mm DC. 2700K CCT.
4	1	10311-PC20	14" Stem Assembly w 1/8 IPS Nipple. White
5	1	11085-PC20	Pendant Stem 14". White

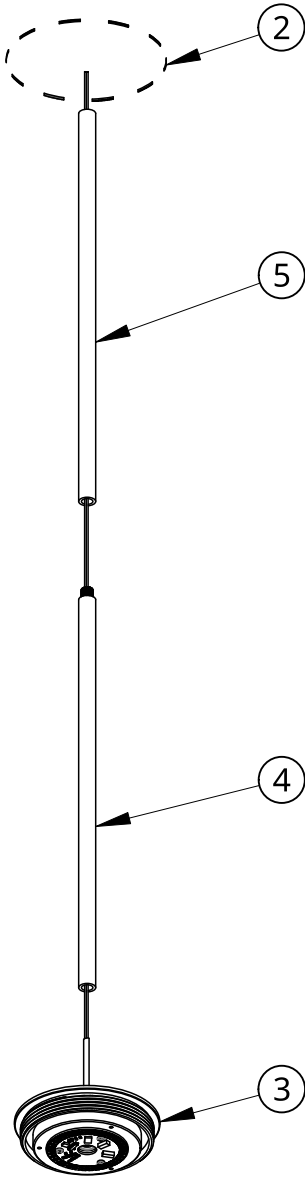

Installation - Canopy & Stems

1. Refer to Canopy Instructions Sheet.

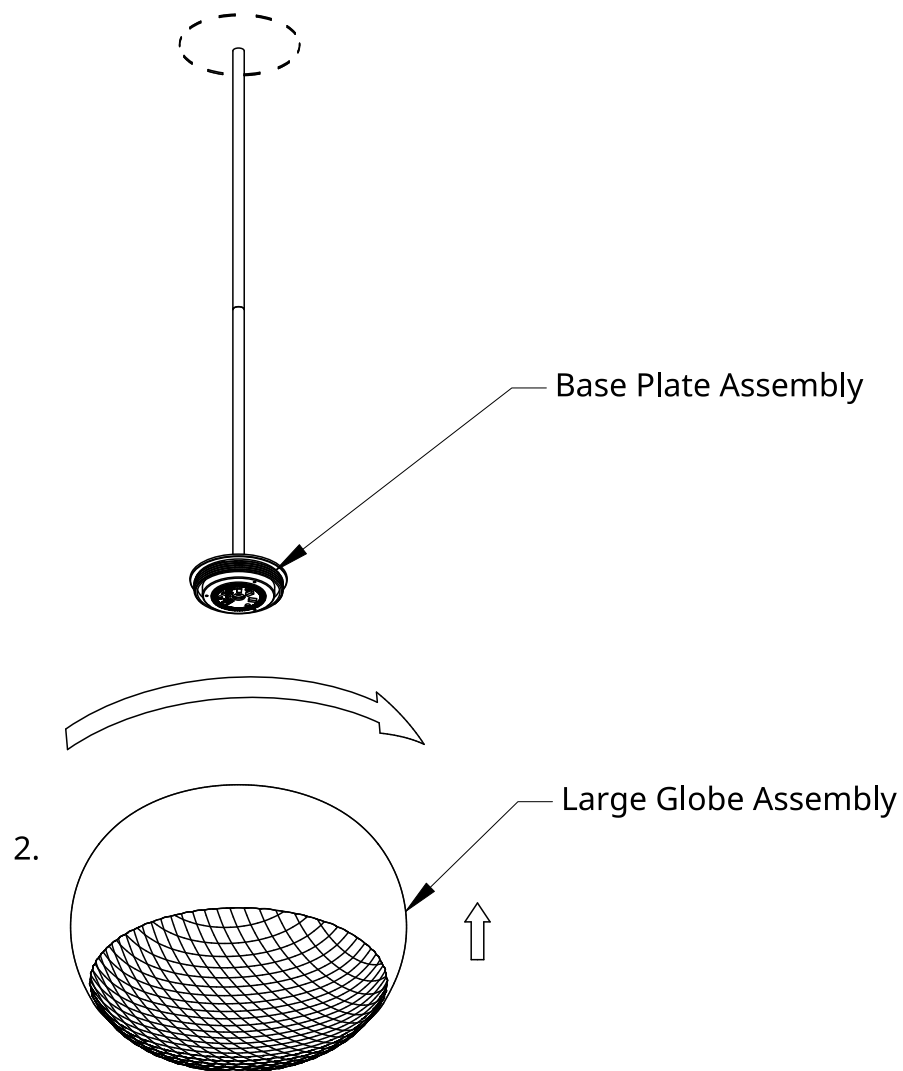

Page intentionally left blank

Installation - Globe Assembly

2. Raise Large Globe Assembly and thread clockwise onto Base Plate Assembly.
3. Congratulations! End of guide.

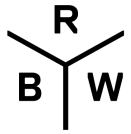

Deep Canopy

13517 rB

Stem Mount

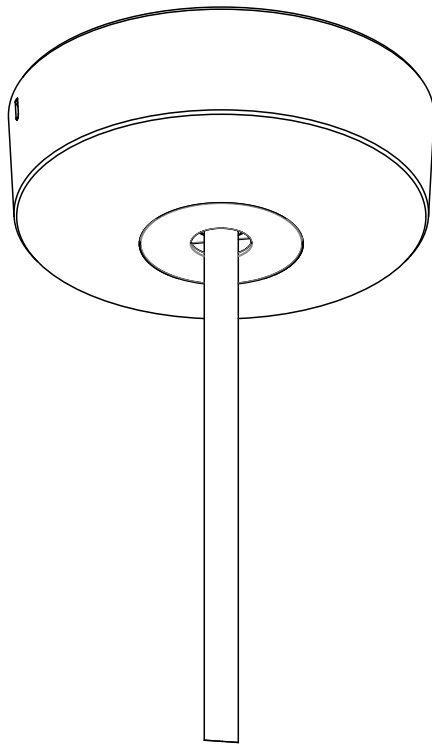

CAUTION:

Before starting, turn off power at main circuit panel.

ADVERTENCIA:

Antes de comenzar la instalación, apague la corriente en el tablero principal.

ATTENTION:

Coupez l'alimentation avant de procéder à l'installation.



Calling for backup? Scan above to contact our team.

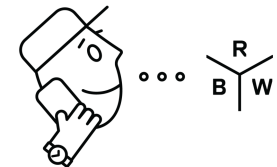
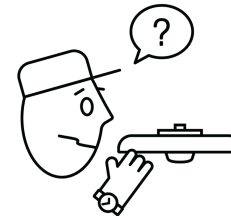

www.RBW.com

+1 212 388 0399

support@RBW.com

© RBW Studio LLC, 2013, 2020

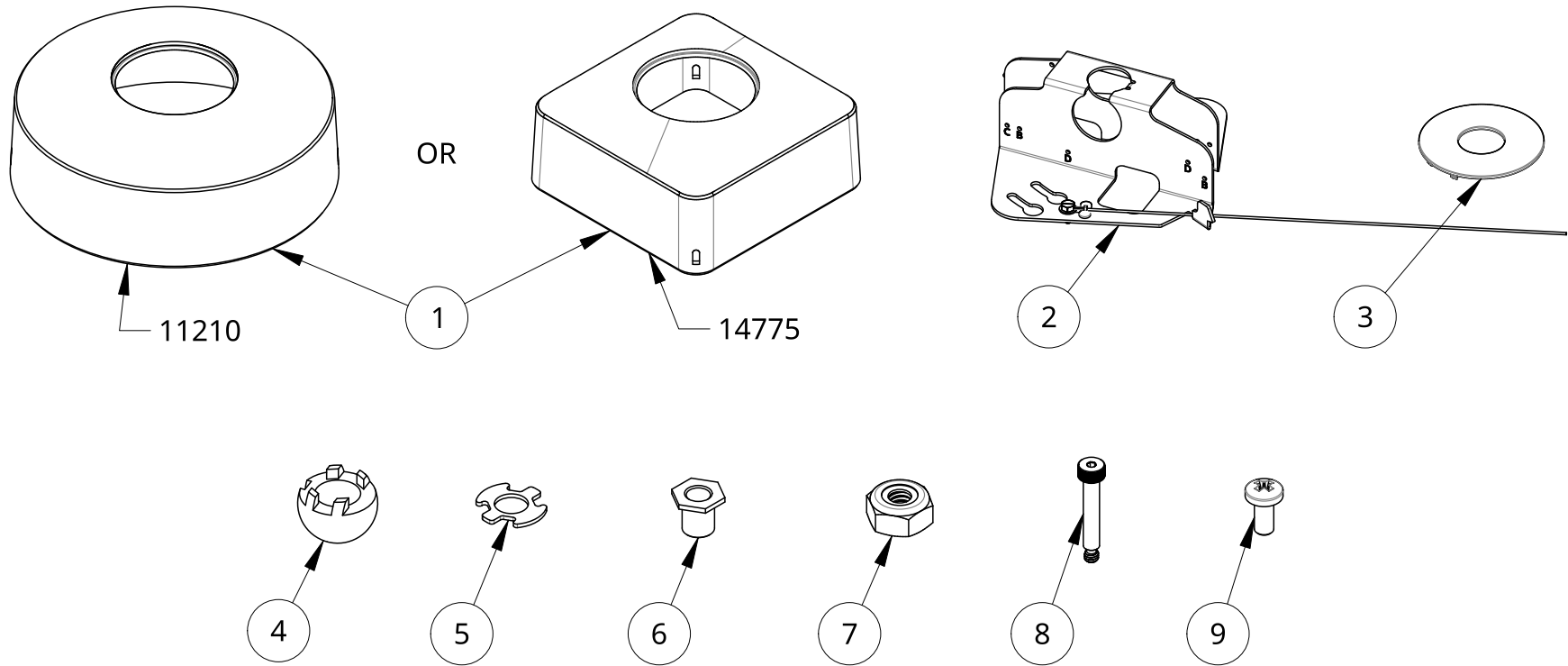

Item	Qty	Part number	Description
1	1	11210	Round Deep Canopy. Matte White
2	1	14233	Assembly: Deep Canopy. Stem Mount
3	1	12674	Canopy: Stem Cover. White
4	1	14905	Universal Swivel Ball. Machined
5	1	14923	Swivel Ball Washer
6	1	NIH902	1/8IPS x 7/16" Hex Nipple - Steel
7	1	90633A009	8-32 Thin Nylock Hex Nut
8	1	91259A168	8-32 x 1" Shoulder Screw
9	4	90272A106	#4-40 x 1/4" ZCS Pan Head Phillips

* If provided driver does not fit in canopy, it must be installed in an external location

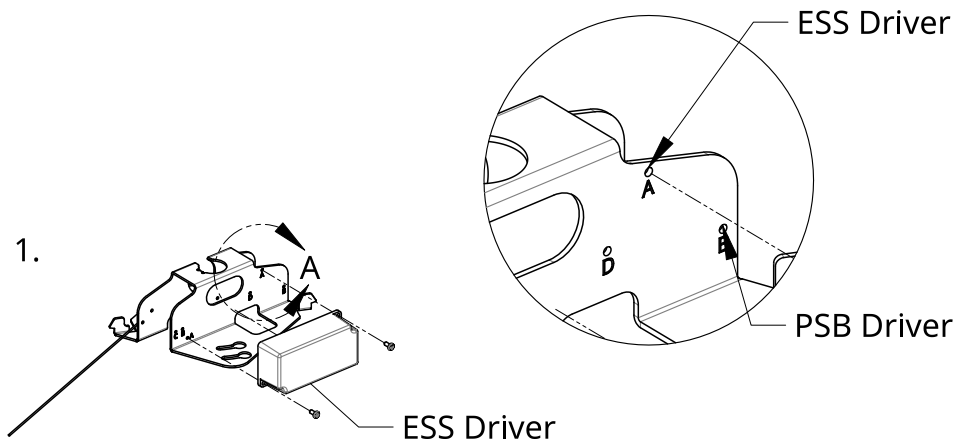
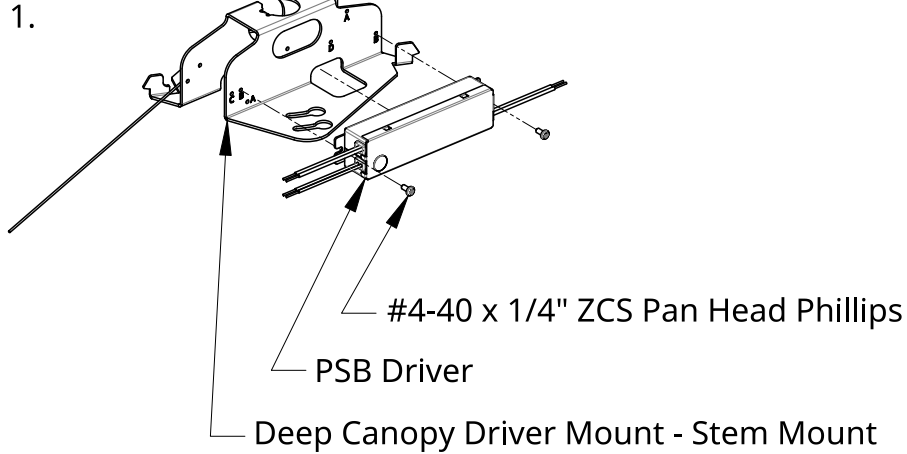

Installation - Driver

1. Fasten included driver to corresponding hole pattern in Driver Mount with #4-40 x 1/4" Pan Head Screws.

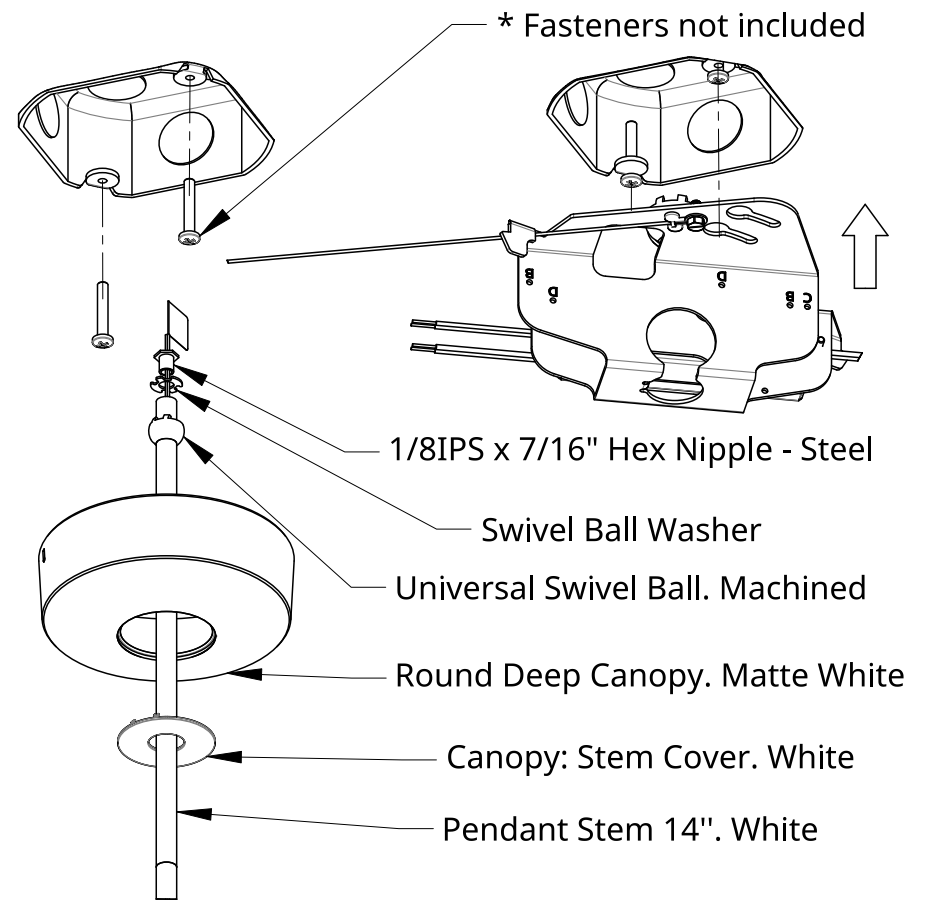

* For adjustable stem steps, refer to Page 4

Installation - Driver Mount

2. Attach appropriate fasteners to desired mounting location leaving enough clearance to secure Driver Mount.
3. Raise Dirver Mount until flush with ceiling and rotate to secure in place.
4. Tighten Fasteners to fully secure Driver Mount.
5. Pass Wires and Pendant Stem through Stem Cover, Deep Canopy and Universal Swivel Ball.
6. Pass Wires through Swivel Ball Washer and 1/8IPS Hex Nipple.
7. Fasten Hex Nipple to Stem to secure Swivel Ball Washer.

* Optional: IF adjusting drop height is desired
For default instructions refer to page 5.

Remove wires from Stem before cutting.

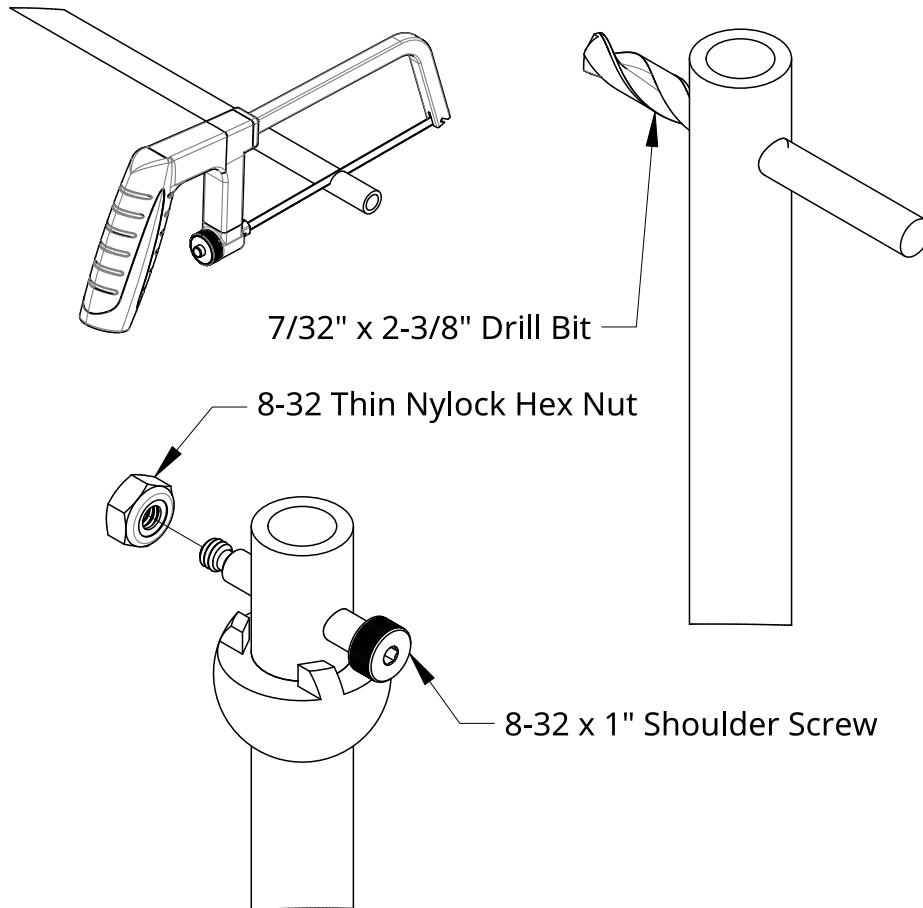

Page intentionally left blank

Installation - Stem Trimming

1. Cut Stem to desired length with an appropriate tool and deburr inside edge.
2. Use included Drill Bit to drill through Stem at least .5 in from the cut edge and deburr hole.
3. Insert Shoulder Screw through drilled holes.
4. Fasten Hex Nut to end of Shoulder Screw.
5. To complete installation continue to page 5 steps.

* Step 2 requires 2 people

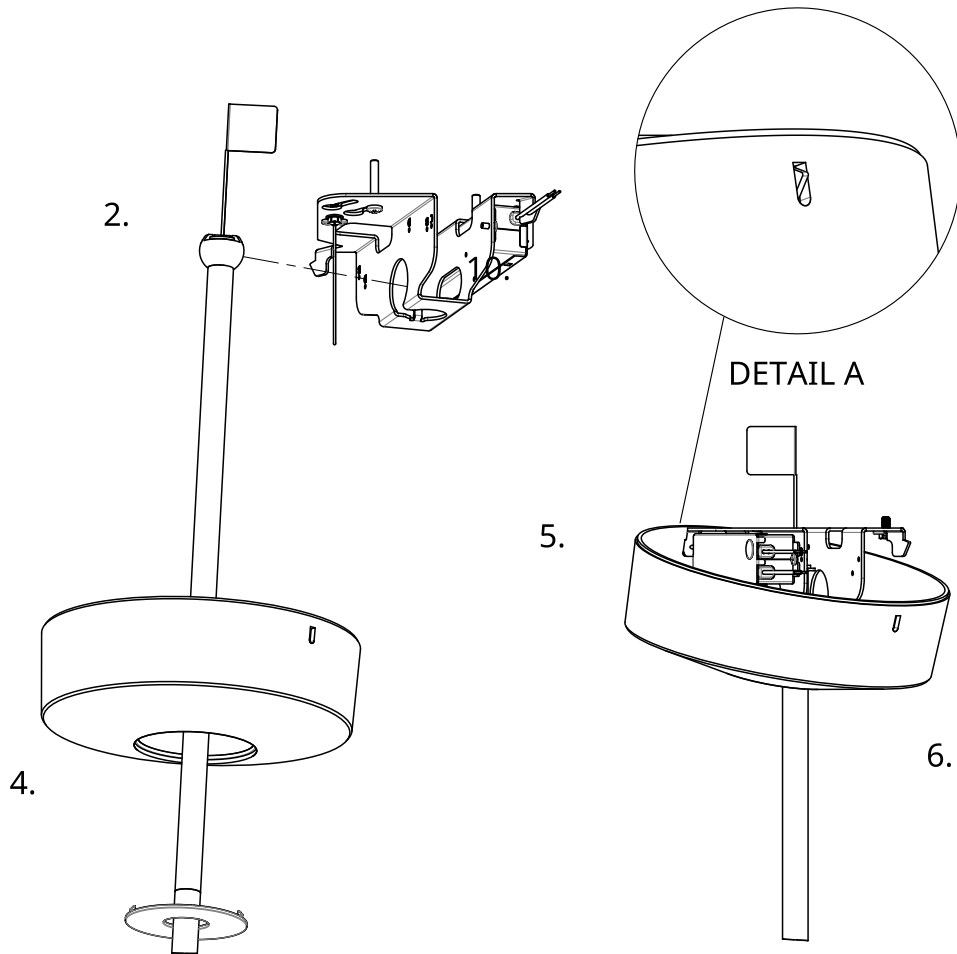

Installation - Driver Mount

1. Connect mains voltage to Driver.
2. Raise product to Driver Mount and pass Swivel Ball through Driver Mount hole, let product hang in the center of the Driver Mount.
3. Feed wires through hole in Driver Mount and connect Red (+) and Black (-) Wires to corresponding driver leads.
4. Raise Round Canopy Cover to the Driver mount and locate the back facing slot in Canopy Cover.

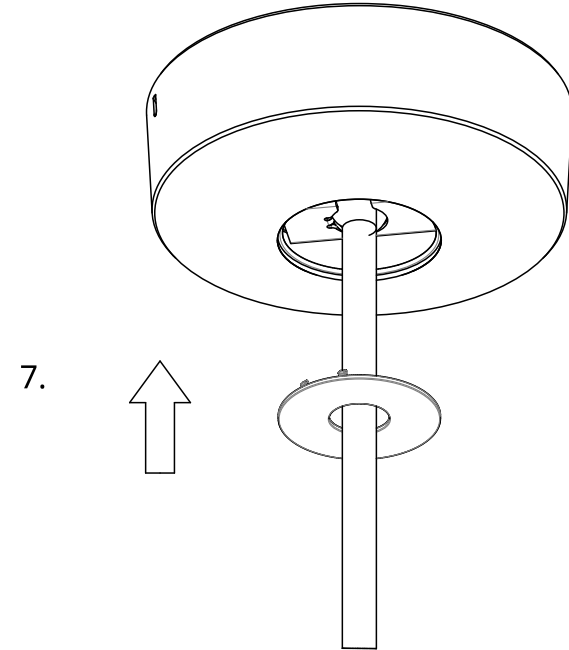

Installation - Canopy Cover & Stem Cover

5. Insert back facing tab from Driver Mount into Canopy Cover slot.
6. Locate front facing slot in Canopy Cover, raise it to corresponding Driver Mount tab and snap in place.
7. Raise Stem Cover to Canopy Cover and snap in place.
8. Congratulations! End of guide.



Print Pendant Cable

12728 rB

Low Voltage Input

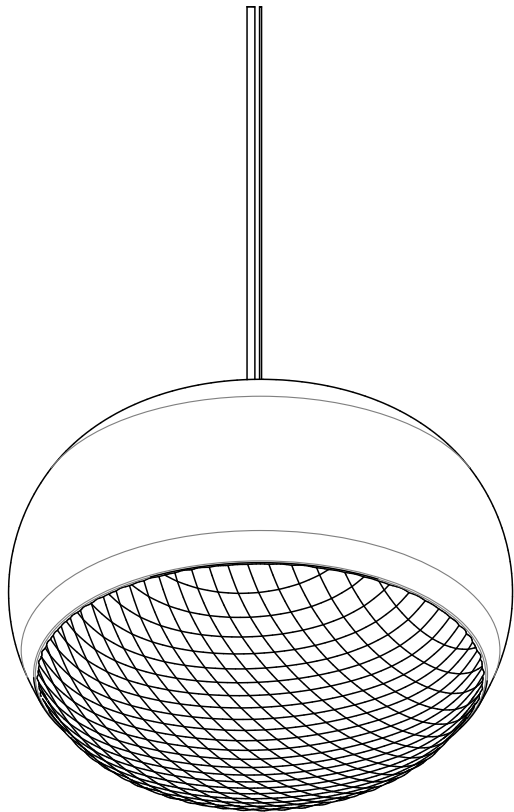

CAUTION:

Before starting, turn off power at main circuit panel.

ADVERTENCIA:

Antes de comenzar la instalación, apague la corriente en el tablero principal.

ATTENTION:

Coupez l'alimentation avant de proceder à l'installation.



Calling for backup? Scan above to contact our team.

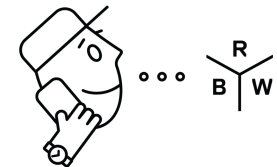

www.RBW.com

+1 212 388 0399

support@RBW.com

© RBW Studio LLC, 2013, 2020

Globe Finish

- Glass Clear/Frosted
- Plastic Clear

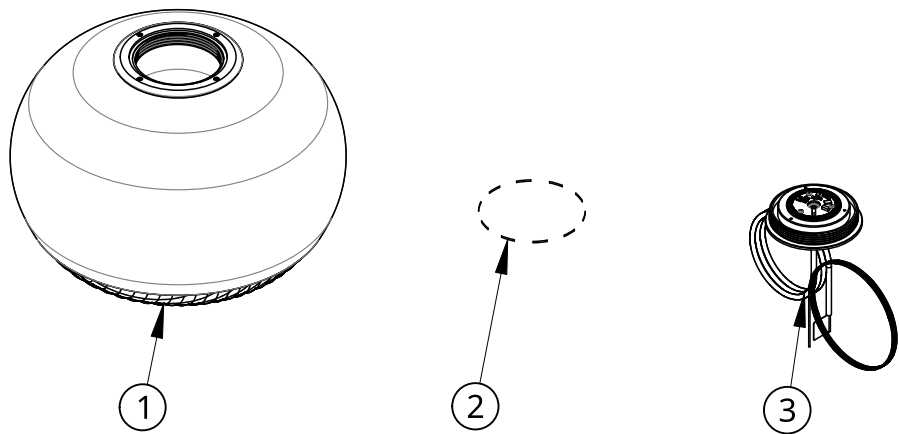

Item	Qty	Part number	Description
1	1	12558	Assembly: Print Large Globe Clear & Frosted Glass
2	1	XXXXX	Canopy Kit
3	1	11995-27	Assembly: Print Pendant (Aircraft Cable) Module. RBW LED 65mm DC. 2700K CCT.

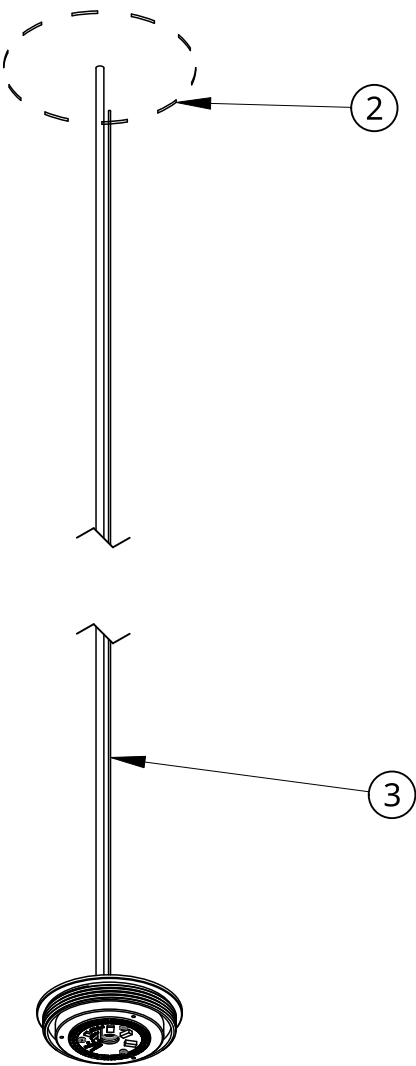

Installation - Canopy

1. Refer to Canopy Instructions Sheet.

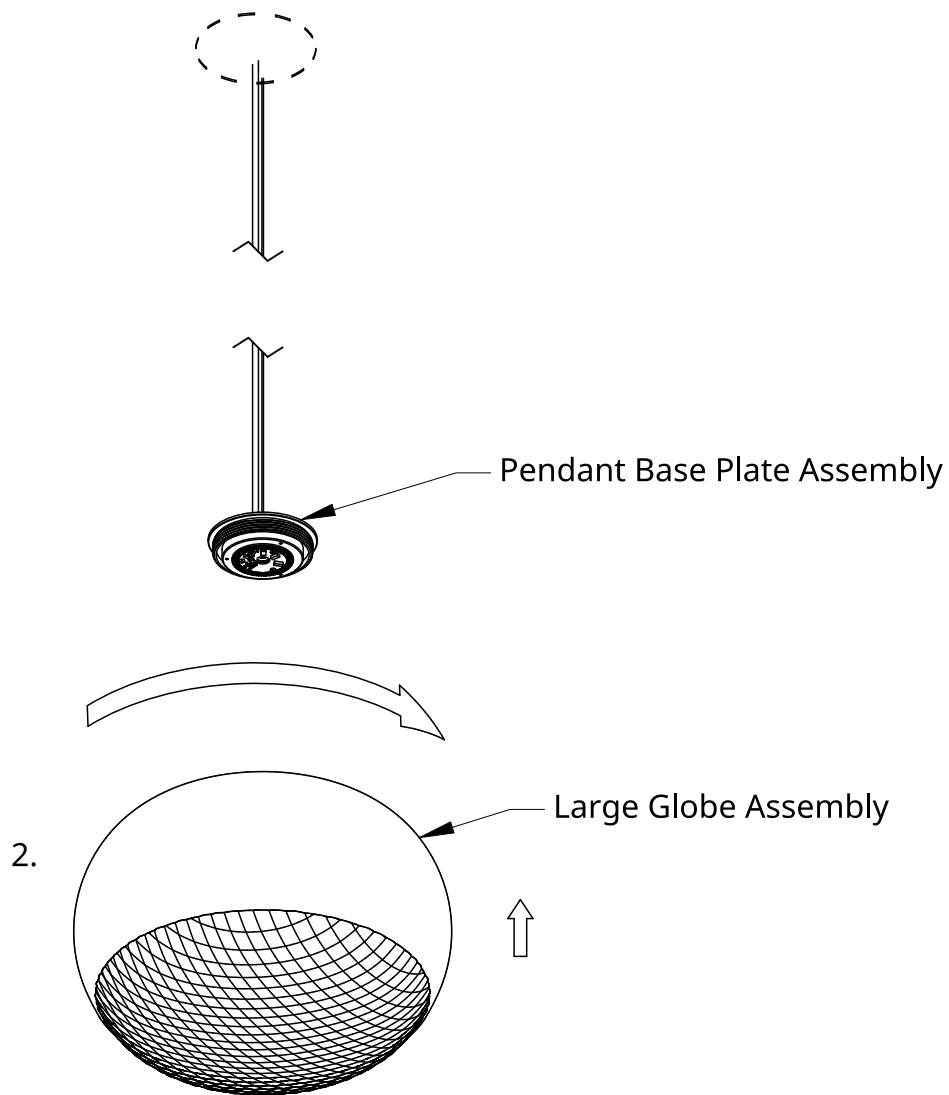

Installation - Globe Assembly

2. Raise Large Globe Assembly and thread clockwise onto Pendant Base Plate Assembly.
3. Move aircraft cable into directional slots to balance fixture as shown in Detail A.
4. Congratulations! End of guide.

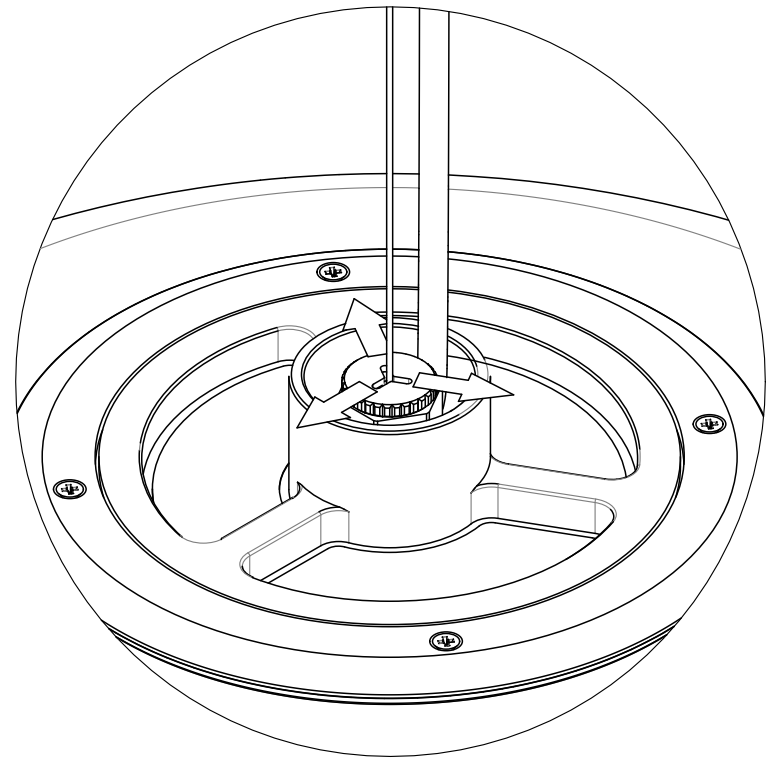

DETAIL A

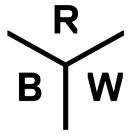

Deep Canopy

13163 rD

Single Cable Suspension

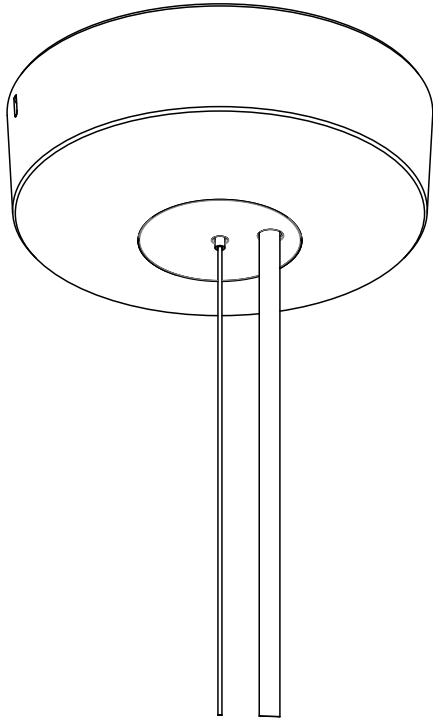

CAUTION:

Before starting, turn off power at main circuit panel.

ADVERTENCIA:

Antes de comenzar la instalación, apague la corriente en el tablero principal.

ATTENTION:

Coupez l'alimentation avant de procéder à l'installation.



Calling for backup? Scan above to contact our team.

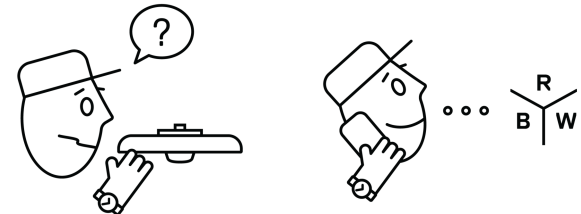

www.RBW.com

+1 212 388 0399

support@RBW.com

© RBW Studio LLC, 2013, 2020

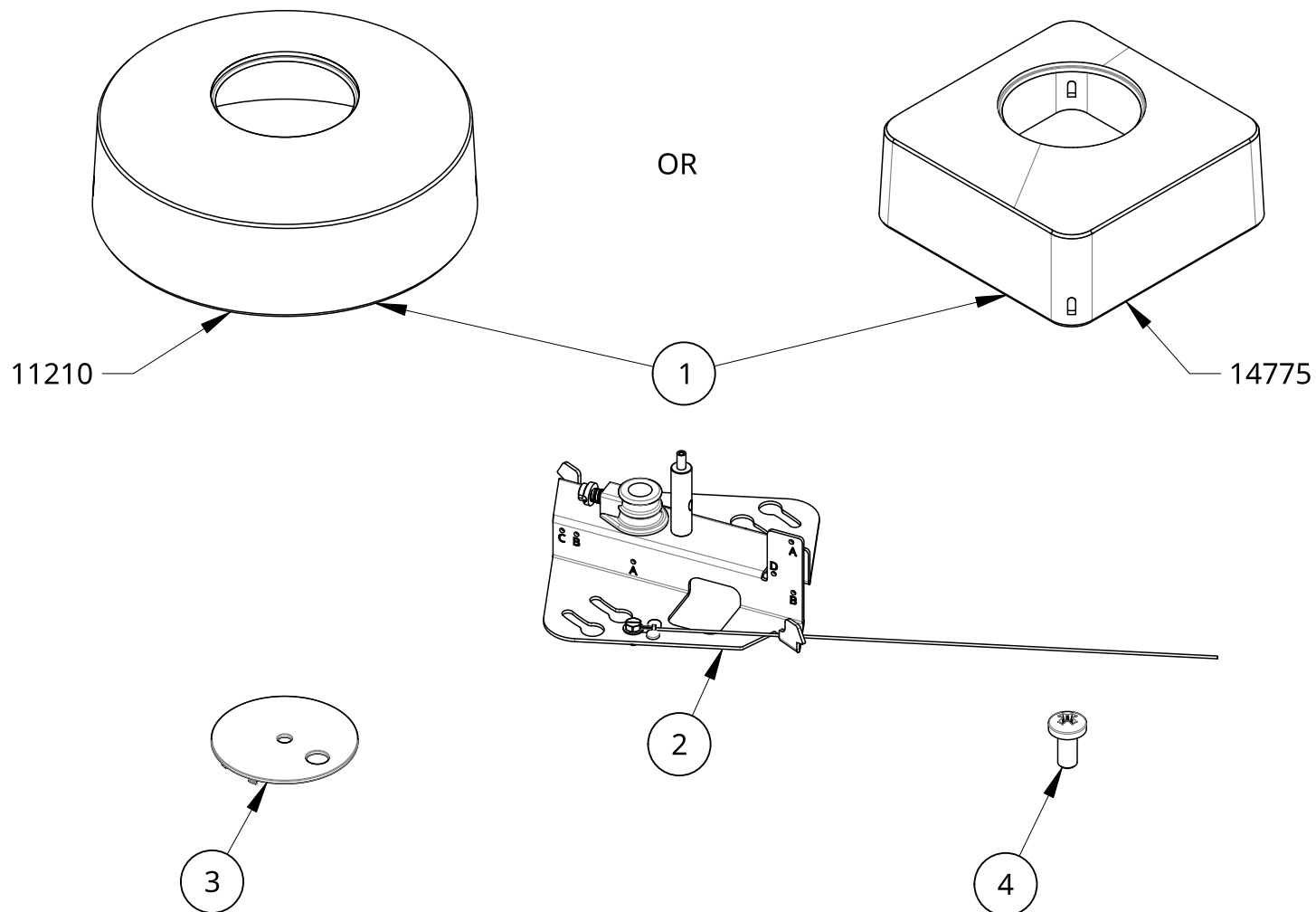

Item	Qty	Description
1	1	Deep Canopy
2	1	Assembly: Deep Canopy. Single Cable Suspension
3	1	Canopy: Single Cable Cover
4	4	#4-40 x 1/4" Pan Head Screw

* If provided driver does not fit in canopy, it must be installed in an external location

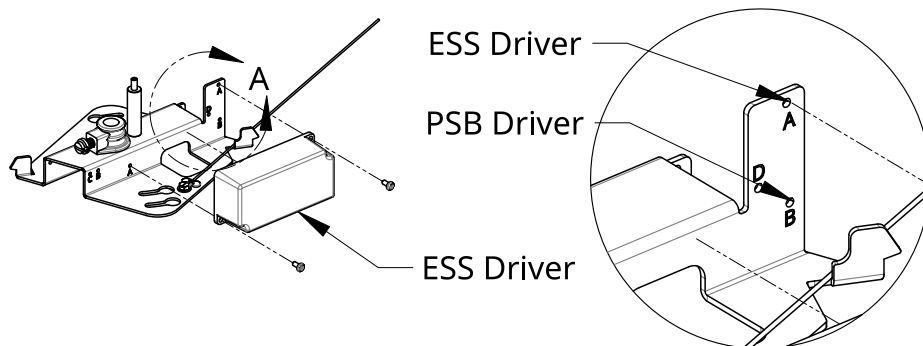
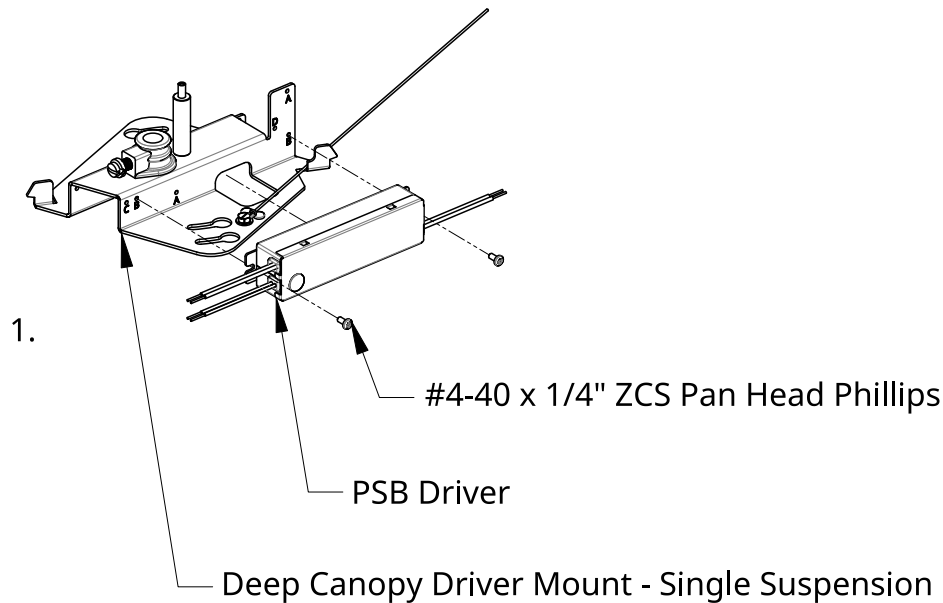

Installation - Driver (skip if driver is remotely located)

1. Fasten included driver to corresponding hole pattern in Driver Mount with #4-40 x 1/4" Pan Head Screws.
2. Connect Power Feed leads to respective Driver leads and tuck wires into the center of the Driver Mount.
3. Connect mains voltage to Driver and connect ground strap according to electrical code.

* Measure approximate hang height, add 3 inches and trim cable and power feed before step 6.

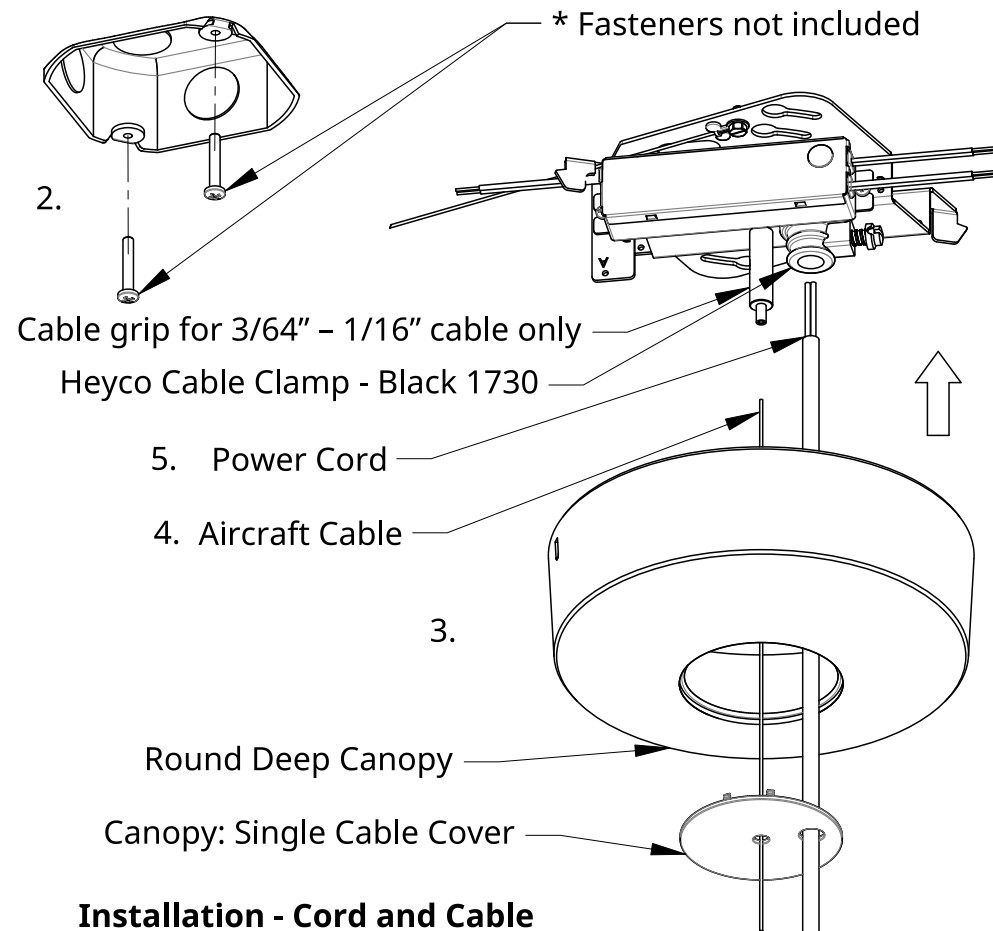

Installation - Cord and Cable

4. Attach appropriate fasteners to desired mounting location leaving enough clearance to secure Driver Mount.
5. Pass product Power Feed and Aircraft Cable through Single Cable Cover and Round Deep Canopy.
6. Feed Aircraft Cable through Cable Grip and adjust to desired length.
7. Insert Power Cord into Heyco Cable Clamp and tighten Cable Clamp at desired length.

* Driver Mount installation requires 2 people

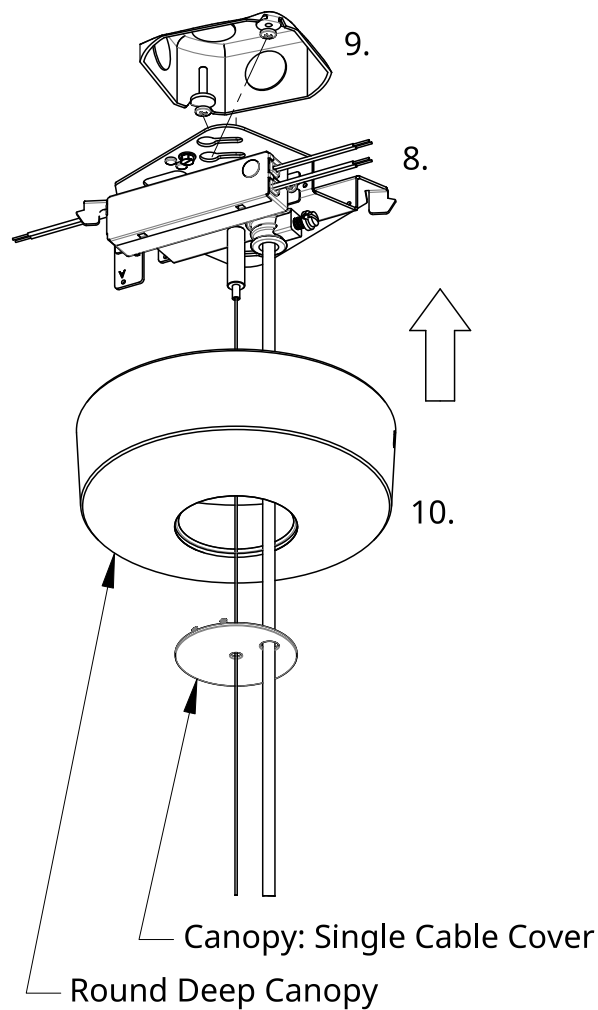

Installation - Driver Mount

8. Raise Driver Mount with hanging product to mounting fasteners and rotate.
9. Tighten Fasteners fully to secure Driver Mount to ceiling mounting surface.

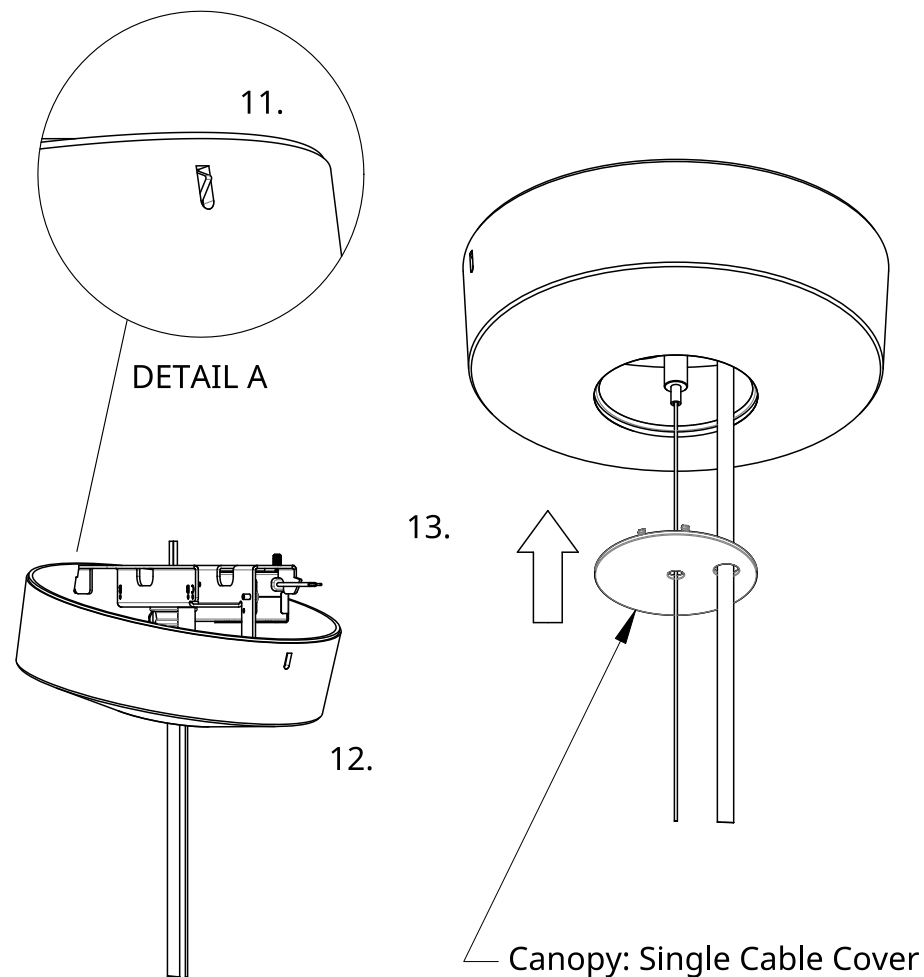

Installation - Canopy Cover & Single Cable Cover

10. Raise Round Deep Canopy to the Driver mount and locate the back facing slot in Canopy Cover.
11. Insert back facing tab from Driver Mount into Deep Canopy slot.
12. Locate front facing slot in Deep Canopy, raise it to corresponding Driver Mount tab and snap in place.
13. Raise Single Cable Cover to Deep Canopy and snap in place.
14. Congratulations! End of guide.